

# PERMANENT BONDING – LONGLASTING SOLUTION

## STEP BY STEP: RED- AND BLUE LINER

Due to permanent bonding, the attachment survives various life situations. The adhesive is modeled on the body and absorbs and releases moisture. Sports or swimming with a hair system is also possible. After the exposure time, the adhesive is ready for hotter temperatures. So a relaxing sauna or a longer holiday is possible without hesitation.

If you still have questions or if you are stuck at a step, you can reach us during our business hours at +49 2241 25527-17.



### Steps 1-8

1.

The Red Liner is applied as adhesive tape to the desired location on the base. The white protective film is removed from the Red Liner for gluing.

2.

The Red Liner can be cut to the desired size. The red protective film remains on the adhesive strip. With pressure on the film the adhesion on the base is achieved. Red Liner products only adhere to PU coatings.

3.

The red protective film is removed from the adhesive strip so that the blue liner can be placed.

4.

While the Red Liner serves as protection against the glue penetrating into the base, the Blue Liner acts as a pressure sensitive adhesive on the skin.

The Blue Liner is attached to the Red Liner. This lasts for 1-3 days. The white protective film is removed from the Blue Liner for gluing.

5.

The Blue Liner must be cut to the size of the Red Liner. The blue protective film remains on the adhesive strip. Adhesion to the Red Liner is achieved by pressing the film.

6.

The blue protective film is removed from the adhesive strip so that the Blue Liner is activated.

7.

The hair system is attached to the vertebral area and rolled off with slight pressure and tension to the side over the head arch up to the forehead. Depending on the hair situation, rolling from the forehead to the spinal area is also possible.

8.

The adhesive is activated by body heat. With the help of a towel and pressure, the glue heats up and the liability is activated.

1.

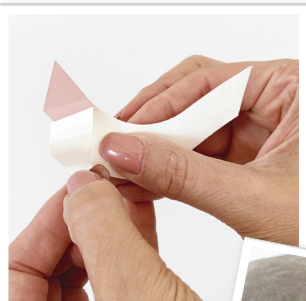

2.



**Tip**  
Clean the scalp and hair system deeply.

3.



4.



5.



7.



6.



8.



**Tip**  
Moisture and heavy loads during the first 24 hours reduce liability.

### Use products



**BLUE LINER**  
Boomerang shape stripes  
749317



**RED LINER**  
Boomerang shape stripes  
749341

or alternatively

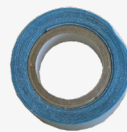

**BLUE LINER**  
Base for glue 749318



**RED LINER**  
Base for glue 749340

### Additional materials required:



**Tip**  
Excess water after showering or swimming must be removed from the adhesive by briefly applying strong pressure with a towel.